

### Ordnance Survey Maps

Source: Extracts submitted by applicant; others reproduced with the permission of the National Library of Scotland from their [map images website](#)

**(i) OS 'Old Series' Map (extract) (1811-1817)**

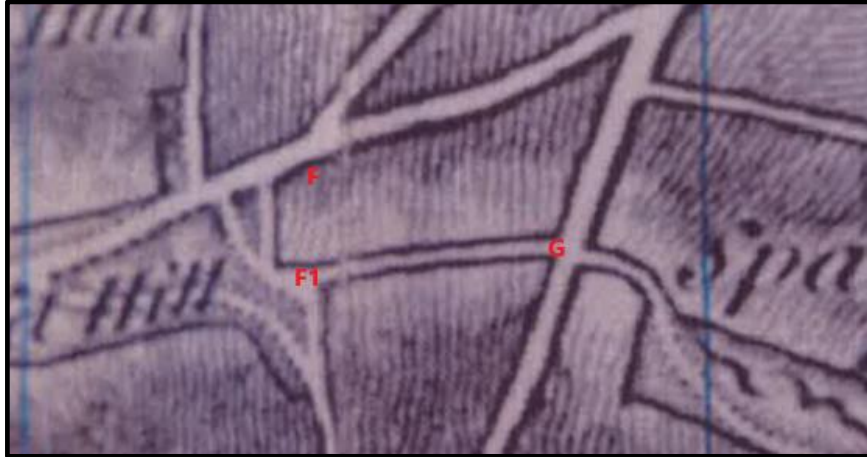

Extract covering application route, red letters F, F1 and G added to mark the application route

**(ii) OS Boundary Remark Book (extracts) (1883)**

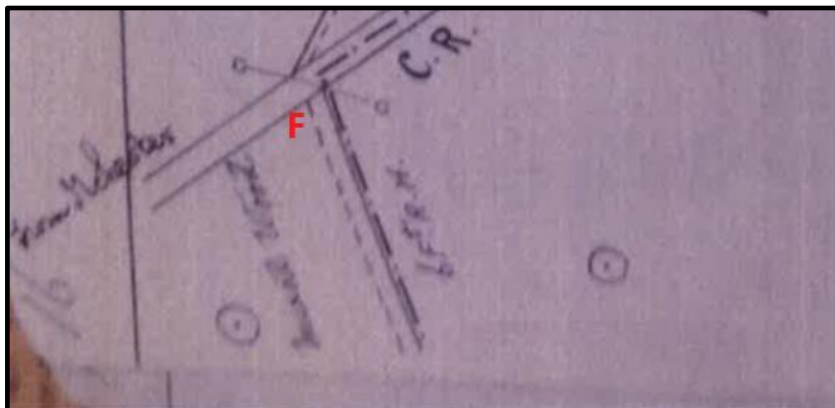

Extract from the OS Boundary Remark book for Sparkford Parish covering part of the application route. The red letter F has been added to mark the route.

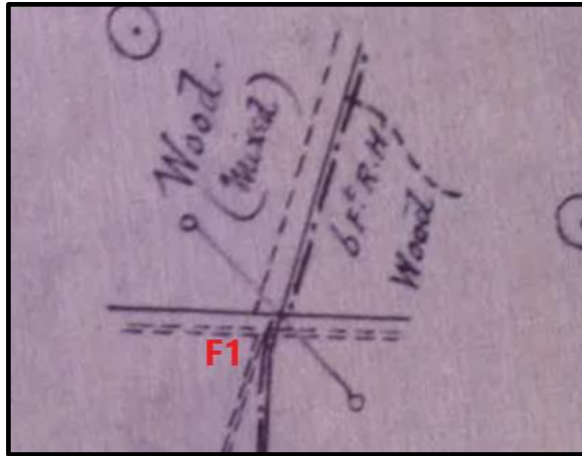

Extract from the OS Boundary Remark book for Sparkford Parish covering part of the application route. The red letter F1 has been added to mark the route.

**(iii) OS Boundary Sketch Map (extract) (1884)**

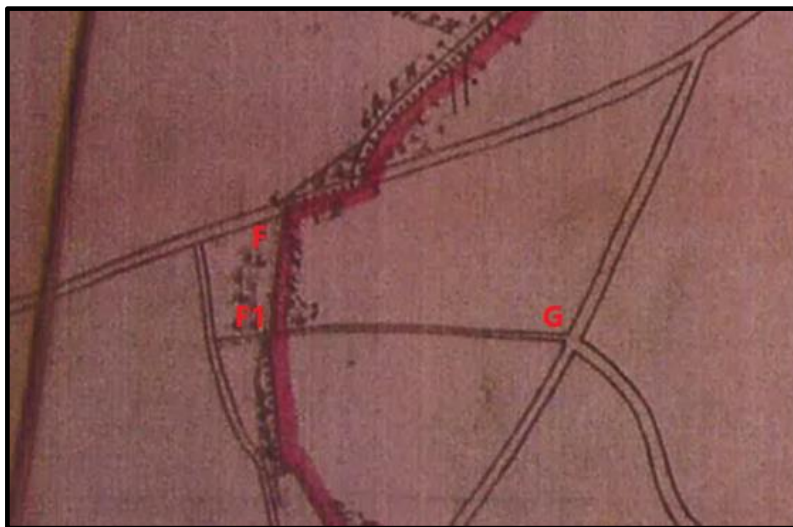

Extract covering application route. Red letters added to mark the application route.

(iv) OS County Series First Edition Map (1887)



Sheet LXXIV.7, red letters added to mark the application route

(v) OS Revised New Series Map (1898)



Sheet 296 covering application route. Red letters F, F1 and G added to mark the route.

<i>Metalled Roads, First Class</i> .....	} Fenced	$\frac{5(\text{Mile distance})}{\text{Altitude}/211}$	} Unfenced
"    " <i>Second Class</i> .....		=====	
"    " <i>Third Class</i> .....		=====	
<i>Unmetalled Roads</i> .....		=====	
<i>Footpaths</i> .....		-----	

Section of map key showing the different classes of road

(vi) OS County Series Second Edition Map (1903)

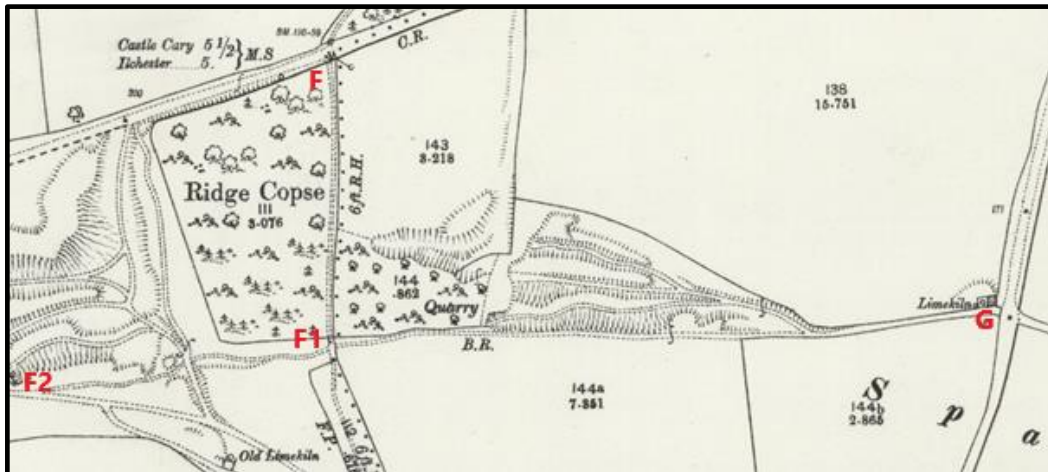

Sheet LXXIV.7 covering application route. Red letters F, F1 and G added to mark the route.

(vii) OS 'Popular Edition' Map (extract) (1919)



Extract covering the application route. Red letters F, F1 and G added to mark the route.

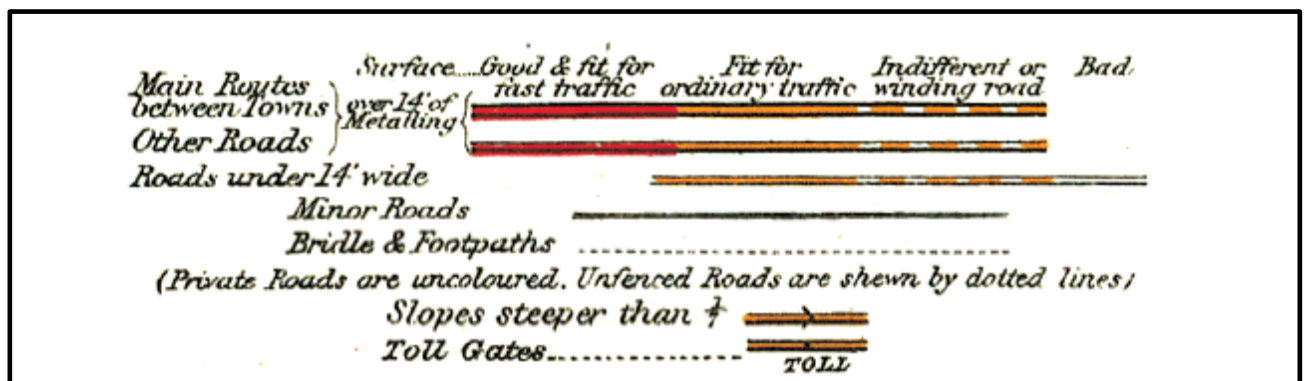

Map key showing road classifications

(viii) OS 'Popular Edition' Map (1946)



Red letters added to mark the application route

Roads	Ministry of Transport, Class 1	A.38
	" " " " 2	B.3210
	14 feet of Metalling and over (not classified by M.of T.)	TOLL
	Under 14 ft. of Metalling Good	Gate
	" " " " Bad	" " "
Minor Roads in towns, Drives and Unmetalled Roads. (Unfenced Roads are shown by pecked lines)		
Footpaths & Bridle Paths		
Steep Gradients, over 1 in 7		over 1 in 5

Map key showing road classifications

Boundaries, Parish	County	-----
" County & Parish	National	+ - +

Map key showing boundaries

(ix) OS 'six-inch' Map (1962)

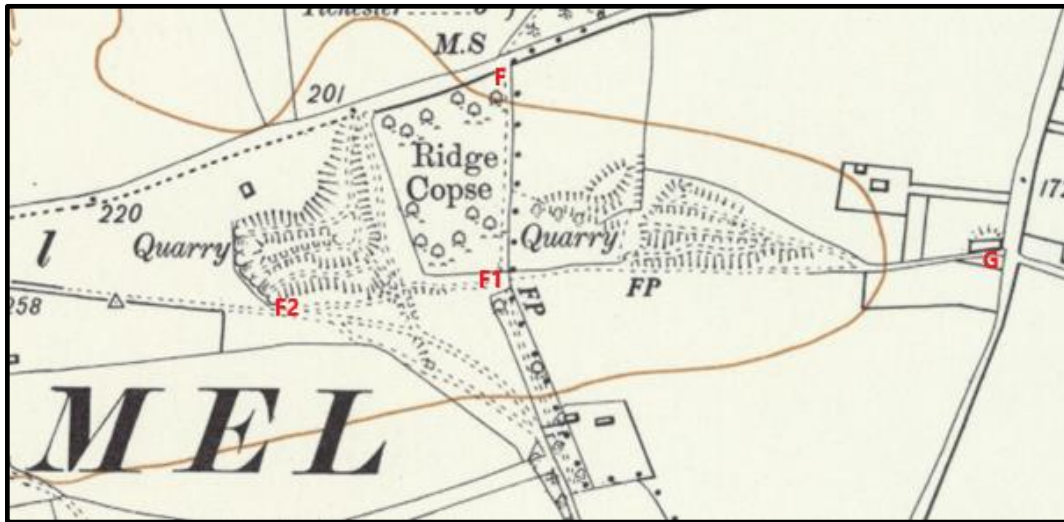

Red letters added for reference

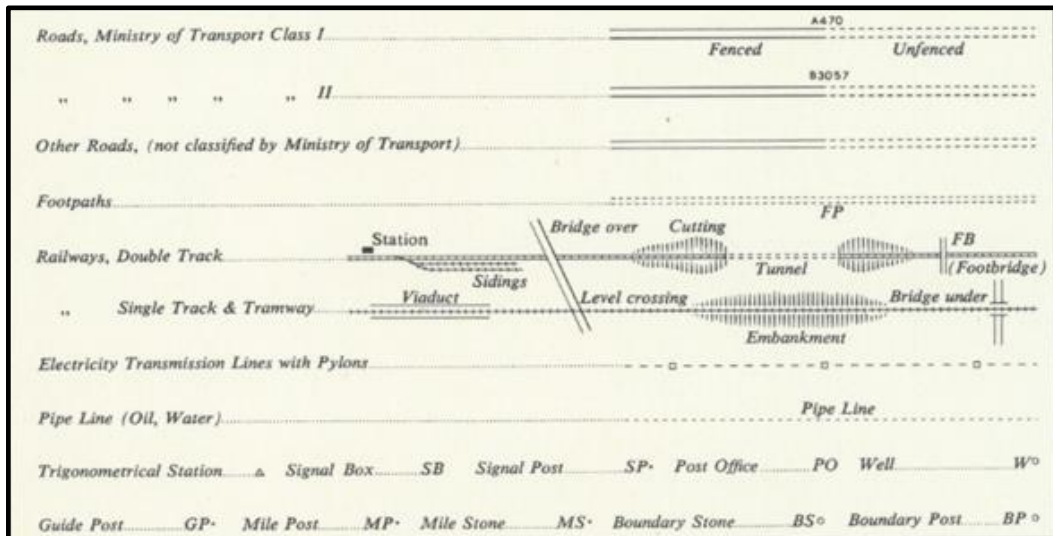

Map key

(x) OS 'six-inch' Map (1886)

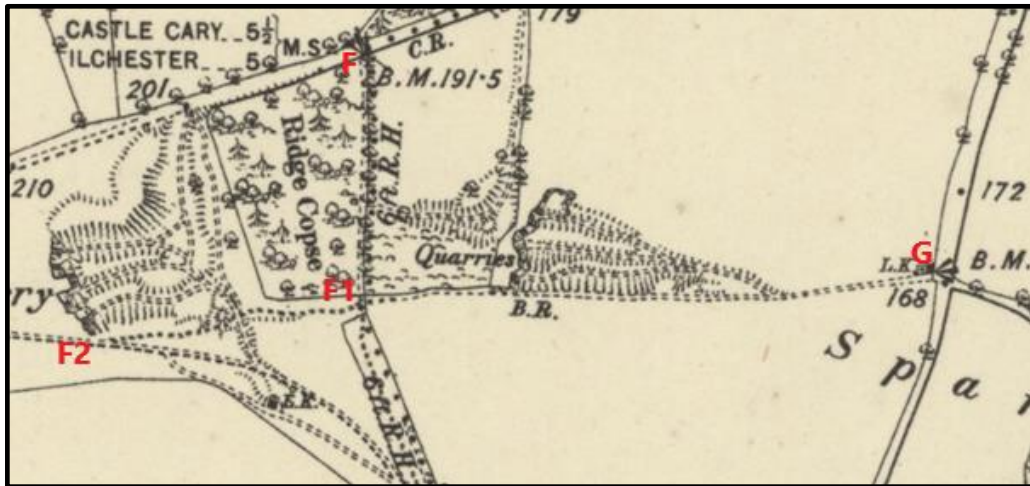

Red letters added for reference

(xi) OS 'six-inch' Map (1904)

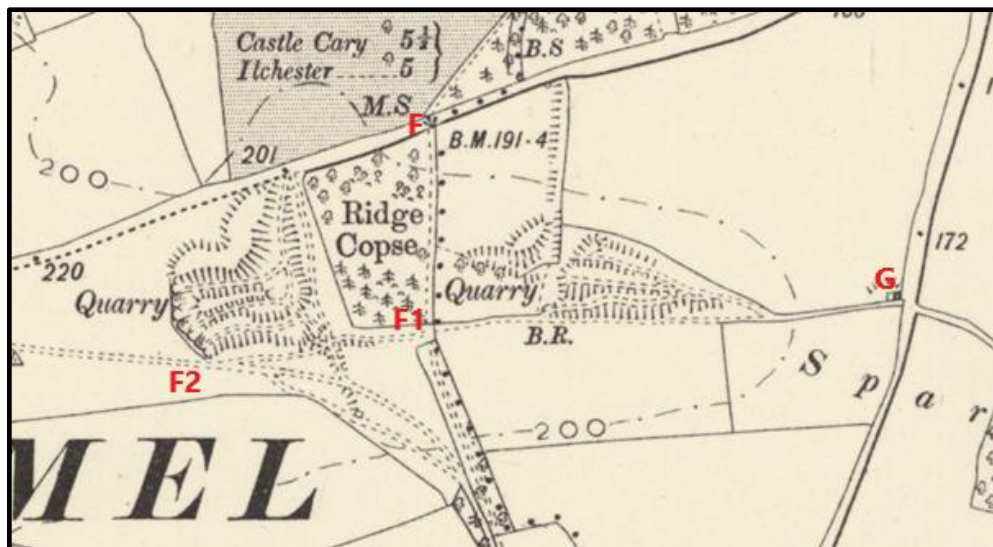

Red letters added for reference